



VIEWRAIL

DriveTite™

EXTERIOR

Installation Instructions



What's in each Kit:

Tensioning Screw



Surface Cover



Cable Stop



Barrel Fitting

Other stuff you'll need: (sold separately)



DriveTite Installation Kit



Stainless Steel Cable



Impact Driver



1/8" Drill Bit

Instructions for Level and Angle Cable Runs

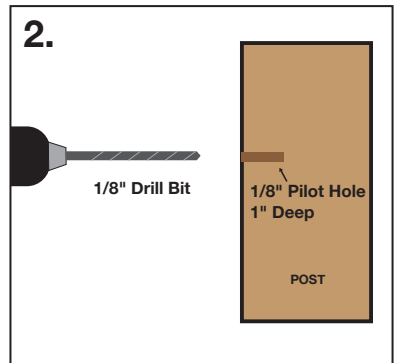
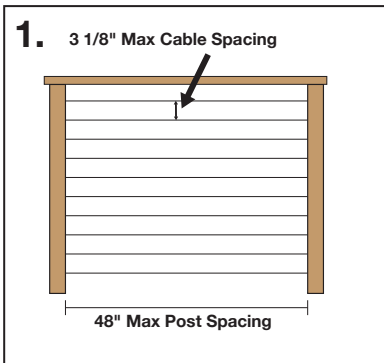

***When installing in hardwoods, make the pilot hole 3/16".**

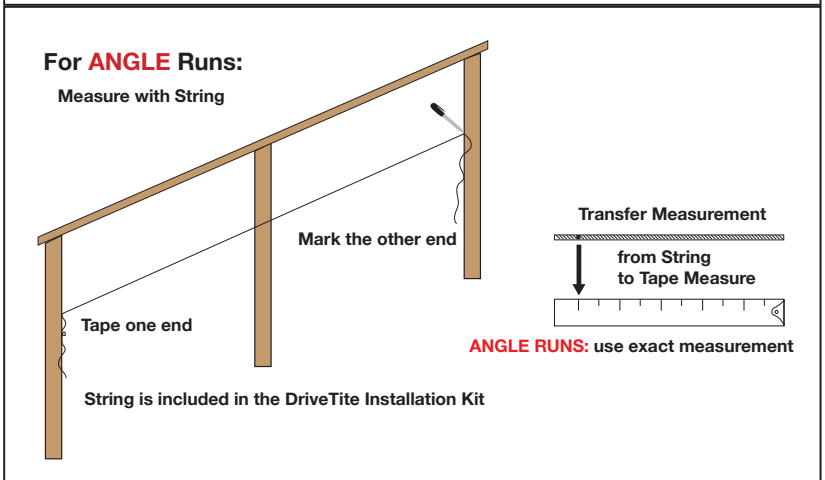
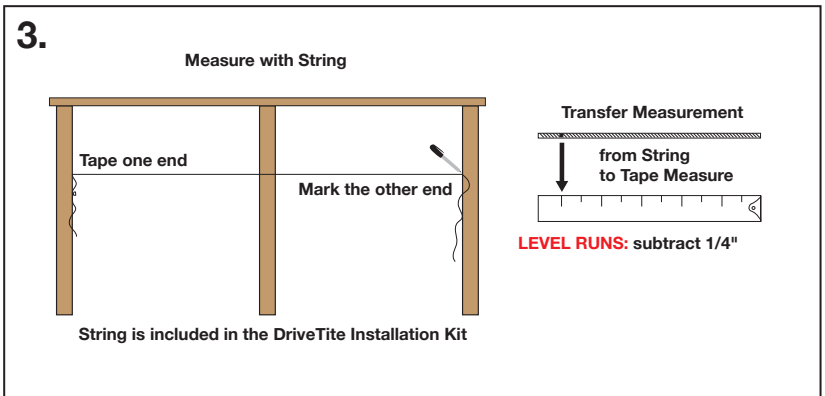

4.

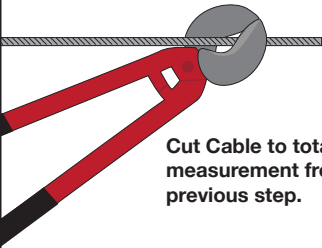

Cut Cable to total measurement from previous step.

5.

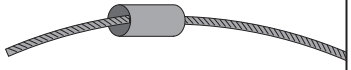

Slide Surface Cover onto Cable. Make sure it is facing the correct direction.

6.

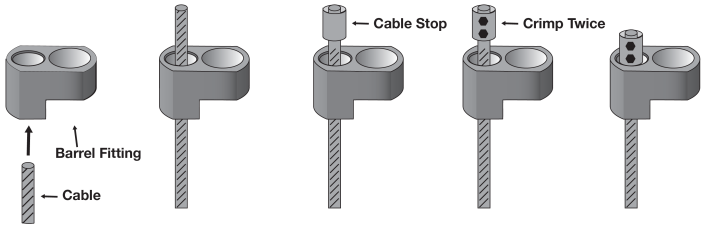

Barrel Fitting
Cable

Cable Stop

Crimp Twice

7.

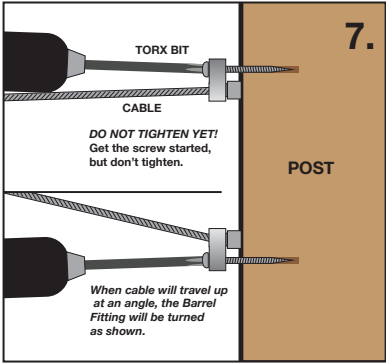

TORX BIT

CABLE

POST

DO NOT TIGHTEN YET!
Get the screw started, but don't tighten.

When cable will travel up at an angle, the Barrel Fitting will be turned as shown.



Repeat steps 2-7 until all cables are mounted.

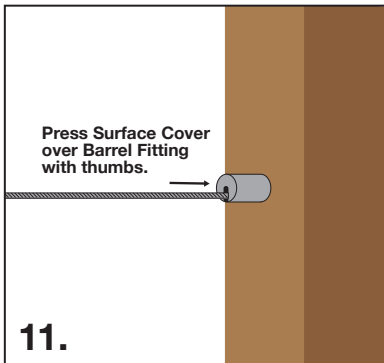
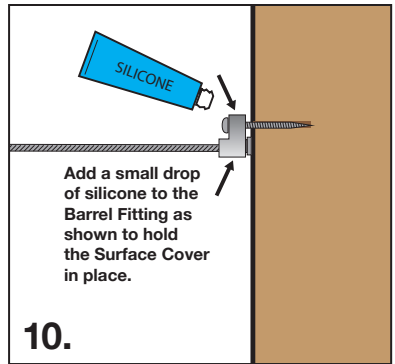
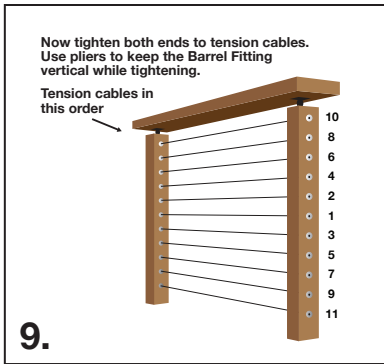

Congratulations on your new Viewrail cable railing system!

Thanks for choosing Viewrail! Please visit our YouTube Channel for helpful installation videos.

www.youtube.com/Viewrail